

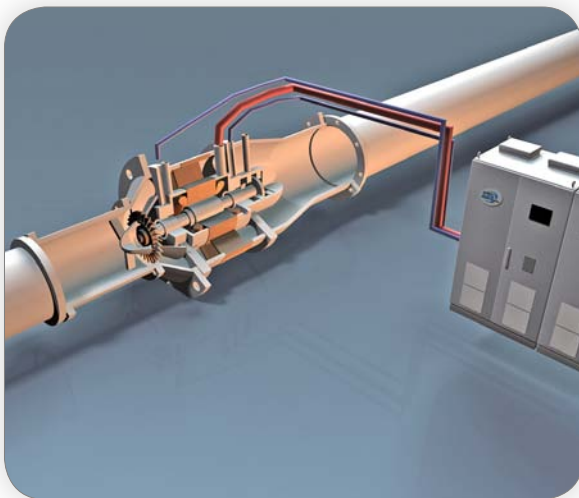

## EXPANDER GENERATOR

Energy prices are continuously rising, increasing the need for optimising energy usage. S2M's high speed generator offers the possibility to recover the energy of a pressurised fluid expanded in a turbine.

By recovering an un-used energy, the pressure let down generator contributes to the reduction of CO2 emissions ! S2M's magnetic bearing further contributes to increase the overall process efficiency.

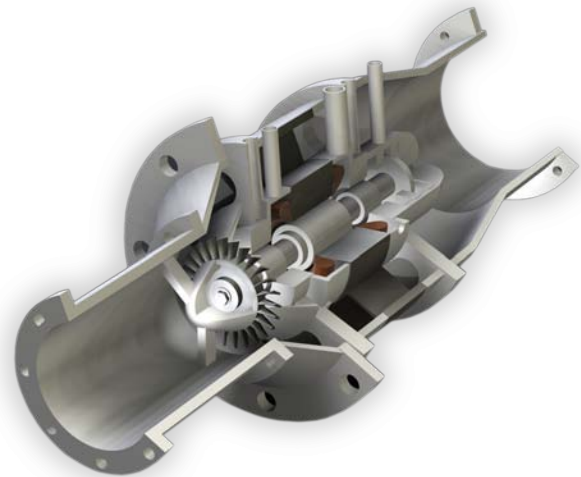

S2M's very compact electromechanical solution can be located in the pipeline itself.



Gas Verbund Mittelland (GVM) natural gas pressure let down recovery station can deliver a total of 600 kW (2 stages).

### Advantages :

- Applicable with multiple fluid/process (ex. natural gaz, air, helium)
- Full-Compliance with IEEE1547 standard for distributed power generation
- Oil-free and contact less rotation
- High efficiency

**Grid Power : 70 -- 300kW**

**Nominal Speed : 30 000 -- 70 000 rpm**

**Total System Efficiency : 92% power efficiency : shaft end to electric grid power conversion**

## CONTACT US

### EUROPE

#### S2M Magnetic Bearings

2, rue des champs  
27 950 St-Marcel France  
[www.S2M.fr](http://www.S2M.fr)  
Phone : +33 232 64 33 00  
Fax : +33 232 21 25 99

### AMERICA

#### SKF Magnetic Bearings

928 - 72nd Avenue NE  
Calgary AB Canada T2E 8V9  
[www.skfmagneticbearings.com](http://www.skfmagneticbearings.com)  
Phone : +1 403 232 9292  
Fax : +1 403 232 9255

### RUSSIA

#### S2M Vostok

6a, building 1,  
8th Marta street,  
Moscow, Russia, 127083  
Phone : +7 (495) 787 56 12  
Fax : +7 (495) 612 18 56

### ASIA

#### S2M Japan

Mita Twin Bldg East Wing,  
4-2-8 Shibaura, Minato-ku,  
Tokyo 108-0023, Japan  
Phone : +81(3)6436-3411  
Fax : +81(3)3456-8171

