

INTEGRATED MOTORIZED COMPRESSOR

This integrated motorized compressor is characterized by its unique shaft line and its sealless design. The assembly of the motor shaft with the compressor shaft is made through a flexible coupling.

The S2M solution : 4 radial bearings (2 for each shaft), and 1 thrust bearing (on the compressor side).

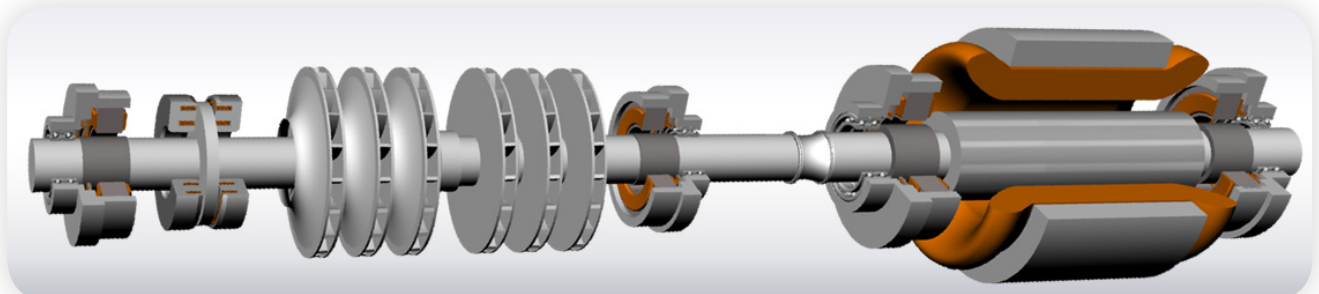

Radial bearing cartridge



GE Integrated Compressor Line with Convertteam high speed motor (application : gas storage facility)

by courtesy of GE Oil & Gas

Advantages :

- Oil free design
- Rotor dynamics control
- Immediate start (no pre-heating)
- Vibration free operation
- Built-in monitoring
- No seal

CONTACT US

EUROPE
S2M Magnetic Bearings
 2, rue des champs
 27 950 St-Marcel France
www.S2M.fr
 Phone : +33 232 64 33 00
 Fax : +33 232 21 25 99

AMERICA
SKF Magnetic Bearings
 928 - 72nd Avenue NE
 Calgary AB Canada T2E 8V9
www.skfmagneticbearings.com
 Phone : +1 403 232 9292
 Fax : +1 403 232 9255

RUSSIA
S2M Vostok
 6a, building 1,
 8th Marta street,
 Moscow, Russia, 127083
 Phone : +7 (495) 787 56 12
 Fax : +7 (495) 612 18 56

ASIA
S2M Japan
 Mita Twin Bldg East Wing,
 4-2-8 Shibaura, Minato-ku,
 Tokyo 108-0023, Japan
 Phone : +81(3)6436-3411
 Fax : +81(3)3456-8171

